



CAST BRONZE FITTINGS

125lb Cast Bronze Pipe Fitting List Prices (BR-0410)

- ✘ *Material Conforms to ASTM B62 (C83600)*
- ✘ *Threads Conform to ASME B1.20.1*
- ✘ *Dimensions Conform to ASME/ANSI B16.15*



800-678-2544 ☎ • 800-678-0857 📠 • www.msi-products.com

Pricing subject to change without notice. © Copyright 2010

MSI 125lb Cast Bronze Price Sheets - BR-0410

800-678-2544

800-678-0857

www.msi-products.com

90° Elbows	Size	Inner Carton	Master Case	Bronze Item Number	Bronze List Price
	1/8"	25	800	A1010002	\$4.13
	1/4"	25	400	A1010004	\$4.13
	3/8"	25	300	A1010006	\$4.13
	1/2"	25	200	A1010008	\$6.29
	3/4"	25	100	A1010012	\$8.46
	1"	25	75	A1010016	\$13.05
	1-1/4"	10	40	A1010020	\$20.76
	1-1/2"	10	40	A1010024	\$25.92
	2"	10	30	A1010032	\$42.20
	2-1/2"	5	15	A1010040	\$82.79
	3"	1	5	A1010048	\$126.98
	4"	1	5	A1010064	\$306.24

45° Elbows	Size	Inner Carton	Master Case	Bronze Item Number	Bronze List Price
	1/8"	25	800	A1010402	\$4.53
	1/4"	25	400	A1010404	\$4.53
	3/8"	25	300	A1010406	\$4.53
	1/2"	25	200	A1010408	\$5.75
	3/4"	25	100	A1010412	\$8.46
	1"	25	75	A1010416	\$14.29
	1-1/4"	10	40	A1010420	\$22.85
	1-1/2"	10	40	A1010424	\$28.63
	2"	10	30	A1010432	\$46.42
	2-1/2"	5	15	A1010440	\$90.93
	3"	1	5	A1010448	\$146.17
	4"	1	5	A1010464	\$334.15

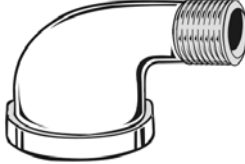
90° Street Elbows	Size	Inner Carton	Master Case	Bronze Item Number	Bronze List Price
	1/8"	25	800	A1010602	\$6.29
	1/4"	25	400	A1010604	\$6.29
	3/8"	25	300	A1010606	\$6.29
	1/2"	25	200	A1010608	\$7.81
	3/4"	25	100	A1010612	\$11.02
	1"	25	75	A1010616	\$18.23
	1-1/4"	10	40	A1010620	\$27.91
	1-1/2"	10	40	A1010624	\$36.36
	2"	10	30	A1010632	\$61.65
	2-1/2"	5	15	A1010640	\$97.46
	3"	1	5	A1010648	\$146.17
	4"	1	5	A1010664	\$438.57

MSI 125lb Cast Bronze Price Sheets - BR-0410

800-678-2544

800-678-0857

www.msi-products.com

45° Street Elbows



Size	Inner Carton	Master Case	Bronze Item Number	Bronze List Price
1/8"	25	800	A1010802	\$6.40
1/4"	25	400	A1010804	\$6.40
3/8"	25	300	A1010806	\$6.40
1/2"	25	200	A1010808	\$7.81
3/4"	25	100	A1010812	\$11.02
1"	25	75	A1010816	\$18.23
1-1/4"	10	40	A1010820	\$27.91
1-1/2"	10	40	A1010824	\$37.48
2"	10	30	A1010832	\$63.53

Unions

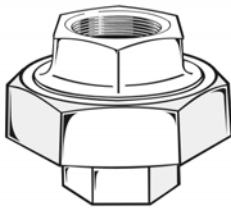

Size	Inner Carton	Master Case	Bronze Item Number	Bronze List Price
1/8"	25	800	A1040802	\$14.66
1/4"	25	400	A1040804	\$14.66
3/8"	25	300	A1040806	\$14.66
1/2"	25	200	A1040808	\$15.94
3/4"	25	100	A1040812	\$22.09
1"	25	75	A1040816	\$29.26
1-1/4"	10	40	A1040820	\$42.85
1-1/2"	10	40	A1040824	\$50.58
2"	10	30	A1040832	\$77.85
2-1/2"	5	15	A1040840	\$153.19
3"	1	5	A1040848	\$236.67
4"	1	5	A1040864	\$522.04

Tees

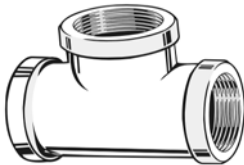

Size	Inner Carton	Master Case	Bronze Item Number	Bronze List Price
1/8"	25	800	A1020002	\$5.75
1/4"	25	400	A1020004	\$5.75
3/8"	25	300	A1020006	\$5.75
1/2"	25	200	A1020008	\$7.23
3/4"	25	100	A1020012	\$10.40
1"	25	75	A1020016	\$18.48
1-1/4"	10	40	A1020020	\$25.92
1-1/2"	10	40	A1020024	\$35.60
2"	10	30	A1020032	\$58.43
2-1/2"	5	15	A1020040	\$113.62
3"	1	5	A1020048	\$173.74
4"	1	5	A1020064	\$417.55

MSI cast bronze pipe fittings meet the following specifications: ANSI/ASME B1.20.1; ASTM B62; ASME B16.15

MSI 125lb Cast Bronze Price Sheets - BR-0410

800-678-2544

800-678-0857

www.msi-products.com

90° Reducing Elbows

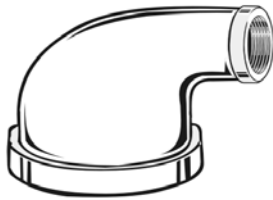

Size	Inner Carton	Master Case	Bronze Item Number	Bronze List Price
1/4" x 1/8"	40	480	A101020402	\$6.40
3/8" x 1/8"	70	840	A101020602	\$6.40
3/8" x 1/4"	60	720	A101020604	\$6.40
1/2" x 1/8"	40	480	A101020802	\$6.80
1/2" x 1/4"	40	480	A101020804	\$6.80
1/2" x 3/8"	50	400	A101020806	\$6.80
3/4" x 1/8"	50	400	A101021202	\$9.26
3/4" x 1/4"	40	320	A101021204	\$9.26
3/4" x 3/8"	25	300	A101021206	\$9.26
3/4" x 1/2"	30	240	A101021208	\$9.26
1" x 1/2"	30	180	A101021608	\$16.25
1" x 3/4"	25	150	A101021612	\$16.25
1-1/4" x 1/2"	35	140	A101022008	\$25.38
1-1/4" x 3/4"	15	120	A101022012	\$25.38
1-1/4" x 1"	10	80	A101022016	\$25.38
1-1/2" x 1/2"	25	100	A101022408	\$32.06
1-1/2" x 3/4"	15	90	A101022412	\$32.06
1-1/2" x 1"	10	80	A101022416	\$32.06
1-1/2" x 1-1/4"	15	60	A101022420	\$32.06
2" x 1/2"	15	60	A101023208	\$59.16
2" x 3/4"	10	60	A101023212	\$59.16
2" x 1"	14	56	A101023216	\$59.16
2" x 1-1/4"	10	40	A101023220	\$59.16
2" x 1-1/2"	10	40	A101023224	\$59.16
2-1/2" x 1"	8	20	A101024016	\$32.06
2-1/2" x 1-1/4"	8	20	A101024020	\$32.06
2-1/2" x 1-1/2"	8	20	A101024024	\$32.06
2-1/2" x 2"	8	20	A101024032	\$32.06
3" x 1-1/4"	5	10	A101024820	\$160.11
3" x 1-1/2"	1	8	A101024824	\$160.11
3" x 2"	1	8	A101024832	\$160.11
3" x 2-1/2"	1	8	A101024840	\$160.11
4" x 2"	1	5	A101026432	\$361.98
4" x 2-1/2"	1	5	A101026440	\$361.98
4" x 3"	1	5	A101026448	\$361.98

Companion Flange



Size (OD)	Inner Carton	Master Case	Bronze Item Number	Bronze List Price
1/2" - (3.50)	25	50	A1061208	\$37.85
3/4" - (3.875)	25	50	A1061212	\$50.64
1" - (4.25)	25	50	A1061216	\$66.80
1-1/4" - (4.375)	18	36	A1061220	\$94.63
1-1/2" - (5.00)	15	30	A1061224	\$109.15
2" - (6.00)	10	20	A1061232	\$175.92

MSI cast bronze pipe fittings meet the following specifications: ANSI/ASME B1.20.1; ASTM B62; ASME B16.15

MSI 125lb Cast Bronze Price Sheets - BR-0410

800-678-2544

800-678-0857

www.msi-products.com

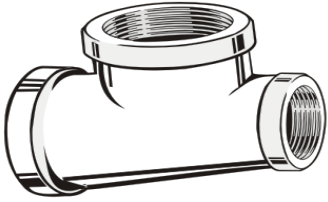
Reducing Tees		Size (1 x 2 x 3)	Inner Carton	Master Case	Bronze Item Number	Bronze List Price
		1/4" x 1/4" x 1/8"	25	300	A10202040402	\$7.09
		3/8" x 3/8" x 1/8"	60	480	A10202060602	\$7.09
		3/8" x 3/8" x 1/4"	40	480	A10202060604	\$7.09
		1/2" x 1/2" x 1/8"	60	360	A10202080802	\$8.77
		1/2" x 1/2" x 1/4"	25	300	A10202080804	\$8.77
		1/2" x 1/2" x 3/8"	45	270	A10202080806	\$8.77
		3/4" x 1/2" x 1/2"	30	180	A10202120808	\$13.70
		3/4" x 1/2" x 3/4"	40	160	A10202120812	\$13.70
		3/4" x 3/4" x 1/4"	25	200	A10202121204	\$12.46
		3/4" x 3/4" x 3/8"	30	180	A10202121206	\$12.46
		3/4" x 3/4" x 1/2"	30	180	A10202121208	\$12.46
		1" x 1/2" x 1/2"	20	120	A10202160808	\$24.80
		1" x 1/2" x 3/4"	20	120	A10202160812	\$24.80
		1" x 1/2" x 1"	15	90	A10202160816	\$24.80
		1" x 3/4" x 1/2"	20	120	A10202161208	\$24.80
		1" x 3/4" x 3/4"	25	100	A10202161212	\$24.80
		1" x 3/4" x 1"	15	90	A10202161216	\$24.80
		1" x 1" x 1/4"	25	150	A10202161604	\$22.77
		1" x 1" x 3/8"	20	120	A10202161606	\$22.77
		1" x 1" x 1/2"	15	120	A10202161608	\$22.77
		1" x 1" x 3/4"	25	100	A10202161612	\$22.77
		1-1/4" x 1" x 1-1/4"	10	60	A10202201620	\$34.79
		1-1/4" x 1-1/4" x 1/2"	20	80	A10202202008	\$32.06
		1-1/4" x 1-1/4" x 3/4"	12	72	A10202202012	\$32.06
		1-1/4" x 1-1/4" x 1"	16	64	A10202202016	\$32.06
		1-1/2" x 1-1/2" x 1/2"	18	72	A10202242408	\$44.16
		1-1/2" x 1-1/2" x 3/4"	10	60	A10202242412	\$44.16
		1-1/2" x 1-1/2" x 1"	13	52	A10202242416	\$44.16
		1-1/2" x 1-1/2" x 1-1/4"	15	45	A10202242420	\$44.16
		2" x 2" x 1/2"	10	40	A10202323208	\$72.17
	2" x 2" x 3/4"	10	40	A10202323212	\$72.17	
	2" x 2" x 1"	12	36	A10202323216	\$72.17	
	2" x 2" x 1-1/4"	8	32	A10202323220	\$72.17	
	2" x 2" x 1-1/2"	8	32	A10202323224	\$72.17	
	2-1/2" x 2-1/2" x 1-1/4"	10	20	A10202404020	\$139.21	
	2-1/2" x 2-1/2" x 1-1/2"	5	15	A10202404024	\$139.21	
	2-1/2" x 2-1/2" x 2"	8	16	A10202404032	\$139.21	
	3" x 3" x 1-1/4"	6	12	A10202484820	\$215.79	
	3" x 3" x 1-1/2"	6	12	A10202484824	\$215.79	
	3" x 3" x 2"	6	12	A10202484832	\$215.79	
	3" x 3" x 2 1/2"	6	12	A10202484840	\$215.79	
	4" x 4" x 1"	2	8	A10202646416	\$501.10	
	4" x 4" x 1-1/4"	2	8	A10202646420	\$501.10	
	4" x 4" x 1-1/2"	2	8	A10202646424	\$501.10	
	4" x 4" x 2"	4	8	A10202646432	\$501.10	
	4" x 4" x 3"	2	6	A10202646448	\$501.10	

MSI 125lb Cast Bronze Price Sheets - BR-0410

800-678-2544

800-678-0857

www.msi-products.com

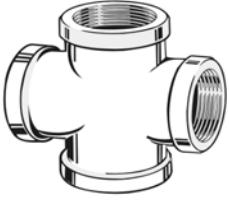
Crosses	Size	Inner Carton	Master Case	Bronze Item Number	Bronze List Price
	1/8"	30	360	A1030202	\$9.60
	1/4"	40	480	A1030204	\$9.60
	3/8"	25	300	A1030206	\$9.60
	1/2"	30	180	A1030208	\$11.67
	3/4"	20	120	A1030212	\$16.86
	1"	15	60	A1030216	\$26.73
	1-1/4"	20	40	A1030220	\$41.84
	1-1/2"	18	36	A1030224	\$53.46
	2"	10	20	A1030232	\$114.41
	2-1/2"	3	12	A1030240	\$208.75
	3"	2	8	A1030248	POA
	4"	2	4	A1030264	POA

Locknuts	Size	Inner Carton	Master Case	Bronze Item Number	Bronze List Price
	1/8"	250	3000	A1040602	\$2.05
	1/4"	125	1500	A1040604	\$2.05
	3/8"	125	1500	A1040606	\$2.05
	1/2"	100	1200	A1040608	\$3.28
	3/4"	60	720	A1040612	\$3.91
	1"	40	480	A1040616	\$5.83
	1-1/4"	30	360	A1040620	\$9.50
	1-1/2"	45	270	A1040624	\$12.31
	2"	25	150	A1040632	\$19.56
	2-1/2"	20	80	A1040640	\$63.49
	3"	20	60	A1040648	\$173.55
	4"	7	28	A1040664	\$353.11

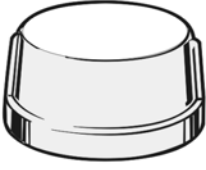
Caps	Size	Inner Carton	Master Case	Bronze Item Number	Bronze List Price
	1/8"	120	1440	A1040502	\$3.10
	1/4"	80	960	A1040504	\$3.10
	3/8"	60	720	A1040506	\$3.10
	1/2"	75	900	A1040508	\$4.13
	3/4"	40	480	A1040512	\$5.46
	1"	35	280	A1040516	\$8.55
	1-1/4"	25	200	A1040520	\$13.02
	1-1/2"	25	150	A1040524	\$17.57
	2"	18	108	A1040532	\$29.82
	2-1/2"	28	56	A1040540	\$56.80
	3"	21	42	A1040548	\$90.55
	4"	7	21	A1040564	\$174.08

MSI cast bronze pipe fittings meet the following specifications: ANSI/ASME B1.20.1; ASTM B62; ASME B16.15

MSI 125lb Cast Bronze Price Sheets - BR-0410

800-678-2544

800-678-0857

www.msi-products.com

Hex Bushings	Size	Inner Carton	Master Case	Bronze Item Number	Bronze List Price
	1/4" x 1/8"	50	600	A104000402	\$3.28
	3/8" x 1/8"	50	600	A104000602	\$3.28
	3/8" x 1/4"	50	600	A104000604	\$3.28
	1/2" x 1/8"	50	600	A104000802	\$3.91
	1/2" x 1/4"	50	600	A104000804	\$3.28
	1/2" x 3/8"	50	600	A104000806	\$3.28
	3/4" x 1/8"	50	600	A104001202	\$5.46
	3/4" x 1/4"	50	600	A104001204	\$5.46
	3/4" x 3/8"	50	600	A104001206	\$4.53
	3/4" x 1/2"	50	600	A104001208	\$4.53
	1" x 1/4"	50	400	A104001604	\$8.31
	1" x 3/8"	50	400	A104001606	\$8.31
	1" x 1/2"	50	400	A104001608	\$6.85
	1" x 3/4"	50	400	A104001612	\$6.85
	1-1/4" x 1/4"	30	240	A104002004	\$14.08
	1-1/4" x 3/8"	30	240	A104002006	\$14.08
	1-1/4" x 1/2"	30	240	A104002008	\$14.08
	1-1/4" x 3/4"	30	240	A104002012	\$11.67
	1-1/4" x 1"	30	240	A104002016	\$11.67
	1-1/2" x 1/4"	25	150	A104002404	\$18.23
	1-1/2" x 3/8"	25	150	A104002406	\$18.23
	1-1/2" x 1/2"	25	150	A104002408	\$18.23
	1-1/2" x 3/4"	25	150	A104002412	\$18.23
	1-1/2" x 1"	25	150	A104002416	\$14.91
	1-1/2" x 1-1/4"	25	150	A104002420	\$14.91
	2" x 1/2"	20	120	A104003208	\$26.61
	2" x 3/4"	20	120	A104003212	\$26.61
	2" x 1"	20	120	A104003216	\$26.61
	2" x 1-1/4"	20	120	A104003220	\$22.09
	2" x 1-1/2"	20	120	A104003224	\$22.09
	2-1/2" x 1/2"	15	60	A104004008	\$54.80
	2-1/2" x 3/4"	15	60	A104004012	\$54.80
2-1/2" x 1"	15	60	A104004016	\$54.80	
2-1/2" x 1-1/4"	15	60	A104004020	\$54.80	
2-1/2" x 1-1/2"	15	60	A104004024	\$44.17	
2-1/2" x 2"	15	60	A104004032	\$44.17	
3" x 1"	12	48	A104004816	\$86.84	
3" x 1-1/4"	12	48	A104004820	\$86.84	
3" x 1-1/2"	12	48	A104004824	\$86.84	
3" x 2"	12	48	A104004832	\$66.80	
3" x 2-1/2"	12	48	A104004840	\$66.80	
4" x 1-1/2"	5	20	A104006424	\$180.99	
4" x 2"	5	20	A104006432	\$180.99	
4" x 2-1/2"	5	20	A104006440	\$153.19	
4" x 3"	5	20	A104006448	\$153.19	

MSI 125lb Cast Bronze Price Sheets - BR-0410





800-678-2544





800-678-0857

www.msi-products.com

Square Head Cored Plugs		Size	Inner Carton	Master Case	Bronze Item Number	Bronze List Price
		1/2"	50	600	A1050008	\$4.33
		3/4"	30	360	A1050012	\$4.95
		1"	20	240	A1050016	\$6.53
		1-1/4"	40	240	A1050020	\$9.71
		1-1/2"	30	180	A1050024	\$12.38
		2"	20	120	A1050032	\$19.54
		2-1/2"	16	64	A1050040	\$33.44
		3"	16	48	A1050048	\$53.46
		4"	8	16	A1050064	\$104.42

Square Head <u>SOLID</u> Plugs		Size	Inner Carton	Master Case	Bronze Item Number	Bronze List Price
		1/8"	50	600	A1250102	\$1.78
		1/4"	50	600	A1250104	\$2.15
		3/8"	50	600	A1050106	\$2.74
		1/2"	50	600	A1050108	\$5.19
		3/4"	30	360	A1050112	\$6.78
		1"	20	240	A1050116	\$11.54
		1-1/4"	40	240	A1050120	\$20.80
		1-1/2"	30	180	A1050124	\$27.03
		2"	20	120	A1050132	\$42.85
		2-1/2"	16	64	A1050140	\$88.29
	3"	16	48	A1050148	\$142.04	
	4"	8	16	A1050164	\$267.15	

Couplings		Size	Inner Carton	Master Case	Bronze Item Number	Bronze List Price
		1/8"	70	840	A1030402	\$4.13
		1/4"	40	480	A1030404	\$4.13
		3/8"	50	600	A1030406	\$4.13
		1/2"	40	480	A1030408	\$5.19
		3/4"	50	300	A1030412	\$6.85
		1"	25	150	A1030416	\$10.40
		1-1/4"	16	128	A1030420	\$16.25
		1-1/2"	18	72	A1030424	\$22.09
		2"	12	48	A1030432	\$36.36
		2-1/2"	8	32	A1030440	\$60.19
	3"	12	24	A1030448	\$83.52	
	4"	6	12	A1030464	\$160.11	

Floor Flange		Size	Inner Carton	Master Case	Bronze Item Number	Bronze List Price
		1/2"	25	50	A1063008	\$11.71
		3/4"	25	50	A1063012	\$16.00
		1"	25	50	A1063016	\$26.22
		1-1/4"	18	36	A1063020	\$29.96
		1-1/2"	15	30	A1063024	\$41.82
		2"	10	20	A1063032	\$55.73

MSI cast bronze pipe fittings meet the following specifications: ANSI/ASME B1.20.1; ASTM B62; ASME B16.15

MSI 125lb Cast Bronze Price Sheets - BR-0410



800-678-2544



800-678-0857

www.msi-products.com

Reducing Couplings

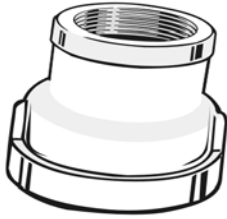

Size	Inner Carton	Master Case	Bronze Item Number	Bronze List Price
1/4" x 1/8"	25	100	A103080402	\$4.43
3/8" x 1/8"	25	100	A103080602	\$4.43
3/8" x 1/4"	25	100	A103080604	\$4.43
1/2" x 1/8"	25	100	A103080802	\$6.40
1/2" x 1/4"	25	100	A103080804	\$5.53
1/2" x 3/8"	25	100	A103080806	\$5.53
3/4" x 1/8"	25	100	A103081204	\$9.14
3/4" x 1/4"	25	100	A103081206	\$9.14
3/4" x 3/8"	25	100	A103081208	\$8.23
3/4" x 1/2"	25	100	A103081606	\$8.23
1" x 1/2"	25	100	A103081608	\$13.69
1" x 3/4"	25	100	A103081612	\$13.69
1-1/4" x 1/2"	10	40	A103082008	\$26.22
1-1/4" x 3/4"	10	40	A103082012	\$22.09
1-1/4" x 1"	10	40	A103082016	\$22.09
1-1/2" x 1/2"	10	40	A103082408	\$31.43
1-1/2" x 3/4"	10	40	A103082412	\$31.43
1-1/2" x 1"	10	40	A103082416	\$27.91
1-1/2" x 1-1/4"	10	40	A103082420	\$27.91
2" x 1/2"	10	40	A103083208	\$46.74
2" x 3/4"	10	40	A103083212	\$46.74
2" x 1"	10	40	A103083216	\$46.74
2" x 1-1/4"	10	40	A103083220	\$41.48
2" x 1-1/2"	10	40	A103083224	\$41.48
2-1/2" x 1"	5	20	A103084016	\$84.15
2-1/2" x 1-1/4"	5	20	A103084020	\$84.15
2-1/2" x 1-1/2"	5	20	A103084024	\$73.47
2-1/2" x 2"	5	20	A103084032	\$73.47
3" x 2"	1	6	A103084832	\$97.39
3" x 2-1/2"	1	6	A103084840	\$97.39
4" x 2-1/2"	1	6	A103086440	\$208.75
4" x 3"	1	6	A103086448	\$208.75

MSI cast bronze pipe fittings meet the following specifications: ANSI/ASME B1.20.1; ASTM B62; ASME B16.15



MSI CONDITIONS OF SALE

TERMS:

Net 30 days for all invoices. Discounts may apply. Invoices must be paid within 30 days from invoice date.

FREIGHT ALLOWANCE:

F.O.B. Shipping Point. We prepay and allow freight to destinations within the continental United States on shipments of \$ 1500.00 or more. All MSI Products are combinable within the \$ 1500.00 freight allowance with exceptions of full lengths of any pipe or tubing of any material.

UPS AND PARCEL POST:

Orders are subject to a \$1.85 per package handling charge.

MINIMUM ORDER:

No order for merchandise will be rendered for less than a minimum charge of \$ 50.00 net.

PRICES:

All prices contained within are subject to change without notice.

RETURNED GOODS:

Absolutely no material may be returned without our express written permission and return authorization number. Any material that is authorized to be returned may be subject to a minimum handling charge.

DEFECTIVE MATERIAL:

Any material that proves defective will be replaced at no charge. Our sole responsibility is limited to the actual replacement of the material involved. We accept no responsibility for labor or kindred claims.

ACCURACY:

MSI strives for 100% accuracy on all list and discount quotation at all times. However the list prices in our catalog are to prevail at all times. We therefore reserve the right to correct any errors resulting from such quotations. We also reserve the right to change quantities to standard packaging on common items.